

SPECIFICATIONS

Rated(额定参数): 300V,16A
 Dielectric strength(抗电强度): AC1250V/1 Minute
 Insulation Resistance(绝缘电阻):1000MΩ Min
 Contact Resistance(接触电阻):20mΩ Max
 Screw Torque(扭矩): 0.2Nm (1.7Lb.in)
 Wire Range(线径):18~24AWG
 Strip length(剥线长度):5~6mm
 Temp. range(操作温度): -40℃~+105℃
 MAX Soldering(瞬时温度):+250℃,5s

Housing Material(塑件): PA66 (UL94 V-0)
 Contact(端子): Brass, Tin plating(黄铜镀锡)
 Wire protector(弹片): Bronze(磷铜), Ni plating(镀镍)
 Screw (螺丝): M2.0, Steel, Zinc plating(钢,镀锌)

PITCH RANGE		NOMINAL DIMENSION RANGE	
IN MM		IN MM	
OVER	OVER	OVER	OVER
6 TO	10 TO	30 TO	60 TO
10 TO	24 TO	60 TO	100 TO
±0.10	±0.15	±0.25	±0.30
		±0.30	±0.50
		±0.30	±0.70
			±1.00

Ordering Information

JL 350 - 350 XX G X 1

Pitch 350=3.50PH No.of pins 2P,3P,4P~24P
 Housing Color B=Black G=Green U=Blue R=Red W=White Y=Yellow O=Orange E=Grey
 Packing 0=Pe bog T=Tube A=Troy

Recommended P.C.B Layout(Top Side)

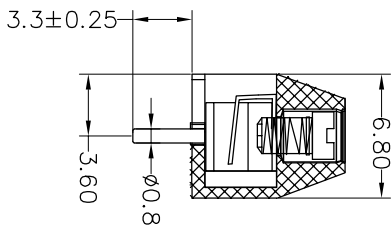
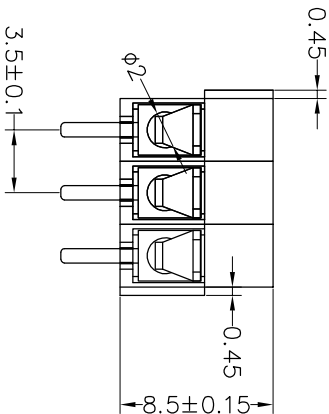
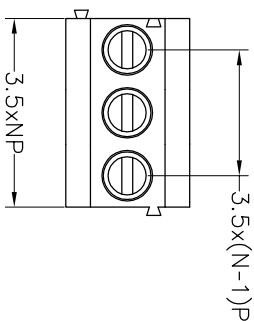
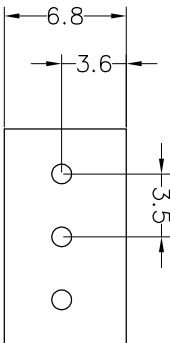

OPERATION		DRAW	BEN	17.01.04	SCALE	FIT	PART NO.	
XX	±0.30				mm	A4	JL350-350XXGX1	
X:XX	±0.20	CHECK						
X:XXX	±0.10							
Angle	±3'	APPROVE						
DIM	TOL							
1	2	3	4	5	6	7	8	9
REV	DATE	MODIFICATION DESCRIPTION	CHANGE			TITLE:	3.50mm Terminal Blocks Female 180°	
A0	2017.01.04	NEW DRAWING						

JIN 深圳市锦凌电子有限公司
 SHENZHEN JINLING ELECTRONIC CO.,LTD
 Tel: 86-755-2997-5806/5802 Fax: 86-755-2997-5992